

# ENGINEER'S REPORT

## 2024 MINI-STORM SEWER CONSTRUCTION SIDNEY STREET | KIMBERLY AVENUE TO PAPERMILL RUN

PREPARED FOR  
**VILLAGE OF KIMBERLY**  
OUTAGAMIE COUNTY, WISCONSIN



MARCH 12, 2024

McMAHON ASSOCIATES, INC.

1445 McMAHON DRIVE NEENAH, WI 54956 Mailing: PO BOX 1025 NEENAH, WI 54957-1025 PH 920.751.4200 MCMGRP.COM  
McM. No. K0001-09-24-00159.00 /BDW:car

**McMAHON**  
ENGINEERS ARCHITECTS

# ENGINEER'S REPORT

MARCH 12, 2024 | McM. No. K0001-09-24-00159.00

## 2024 MINI-STORM SEWER CONSTRUCTION SIDNEY STREET | KIMBERLY AVENUE TO PAPERMILL RUN

PREPARED FOR  
**VILLAGE OF KIMBERLY**  
OUTAGAMIE COUNTY, WISCONSIN

### TABLE OF CONTENTS

PROJECT LOCATION MAP
ENGINEER'S REPORT
2024 MINI-STORM SEWER CONSTRUCTION
Purpose of the Mini-Storm Sewer Project
Establishment of the Sidney Street Mini-Storm Assessment Rate
FINANCING OF ASSESSMENTS
PLANS & SPECIFICATIONS
PUBLIC HEARING
BID TABULATION
SCHEDULE OF ASSESSMENTS



w:\PROJECTS\K0001\092400159\CADD\GIS\2024\_SidneyMiniStorm\_A.mxd March 7, 2024 kpk

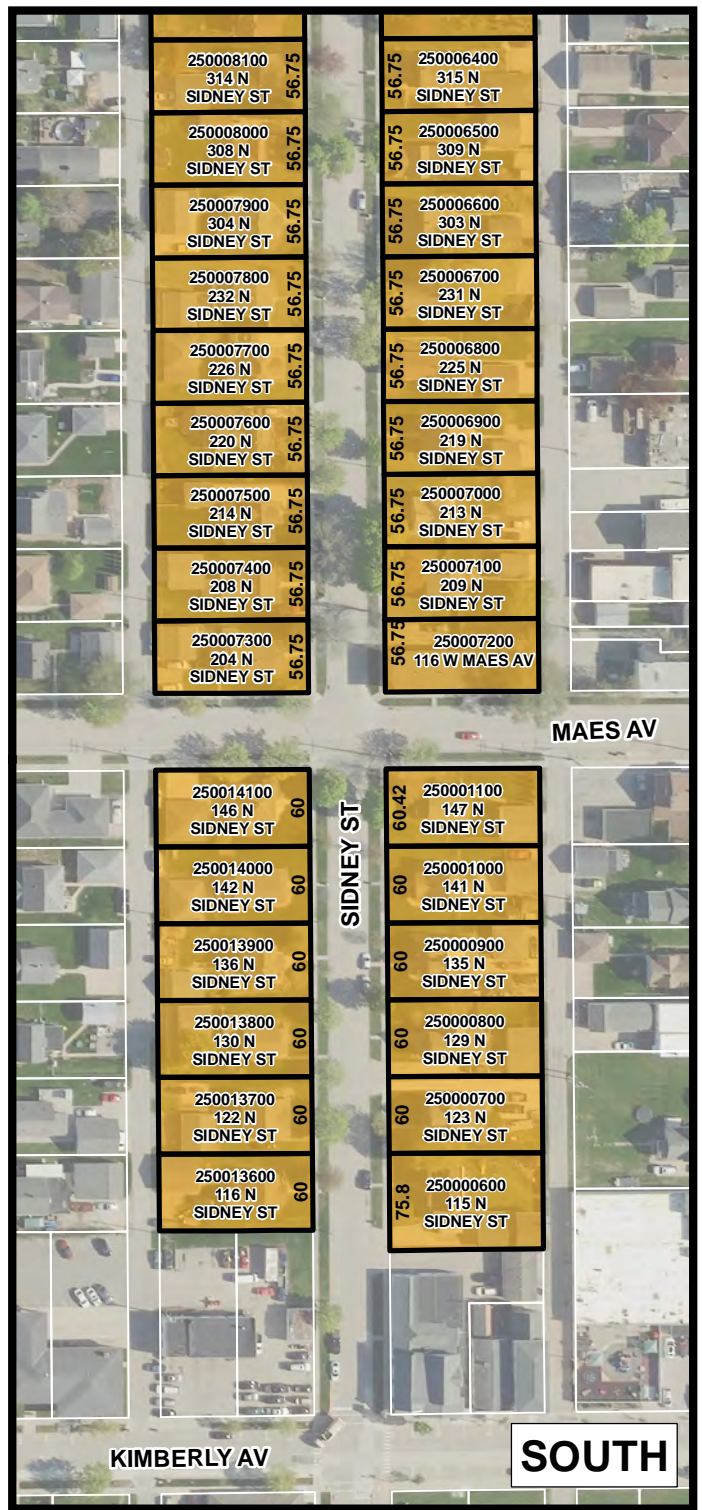
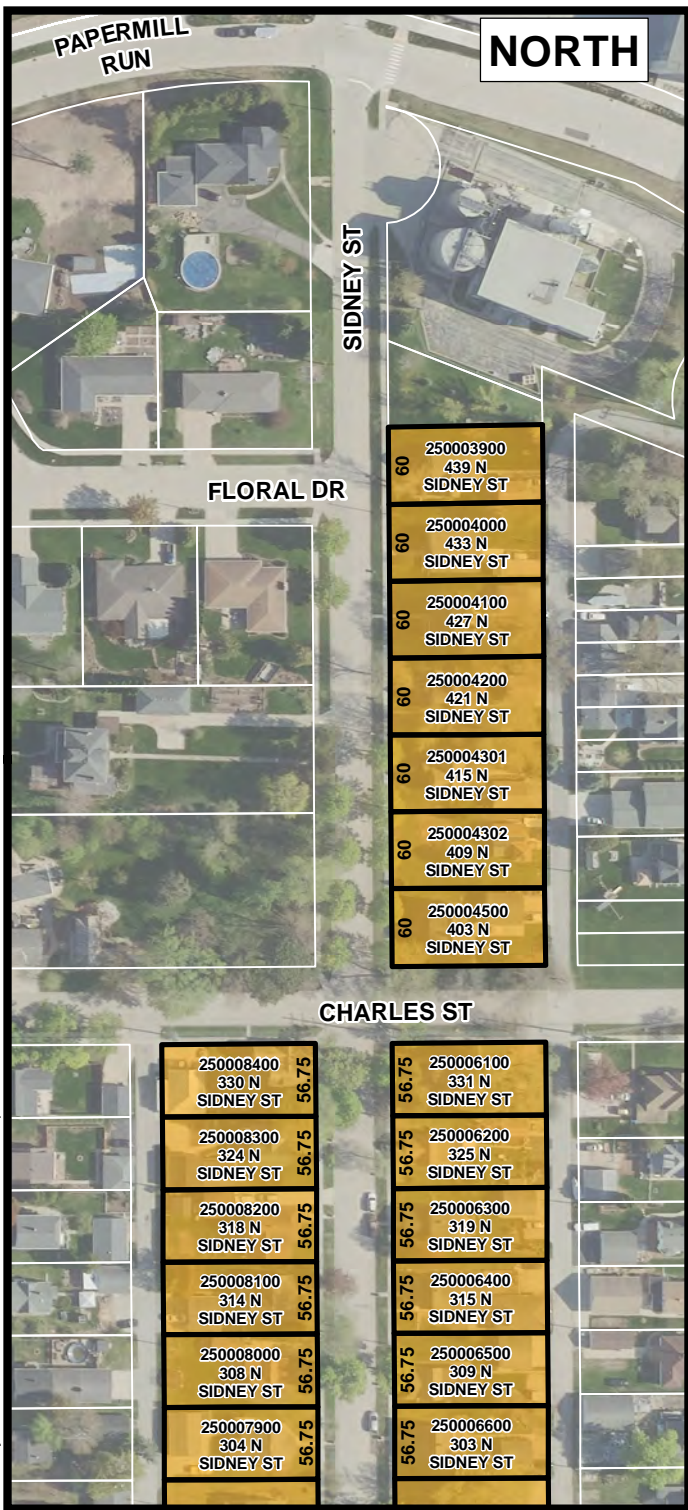

**Mapped Features**

- Mini-Storm Parcel
- Parcel Line

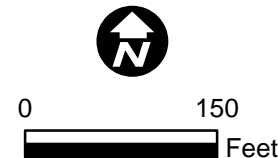

**FIGURE 1**  
**SIDNEY STREET**  
 2024 SIDNEY STREET  
 MINI-STORM SEWER  
 VILLAGE OF KIMBERLY  
 OUTAGAMIE COUNTY, WISCONSIN

Information on this drawing was developed or obtained by others. McMAHON ASSOCIATES, INC does not guarantee this information to be correct, current, or complete. The property and right-of-way information are only intended for use as a general reference and are not intended or suitable for site-specific uses. Any use to the contrary of the above stated uses is the responsibility of the user and such use is at the user's own risk.

# ENGINEER'S REPORT

MARCH 12, 2024 | McM. No. K0001-09-24-00159.00

## 2024 MINI STORM SEWER CONSTRUCTION SIDNEY STREET | KIMERLY AVENUE TO PAPERMILL RUN

PREPARED FOR  
**VILLAGE OF KIMBERLY**  
OUTAGAMIE COUNTY, WISCONSIN

1. This Engineer's Report, submitted on behalf of the above-named municipality, is prepared in compliance with Section 66.0703(1)(b), Wisconsin Statutes, and Section 66.0703(3), Wisconsin Statutes, as amended.
2. That all Preliminary and Final Plans and Specifications for the aforementioned municipal project are on file with the Clerk of the municipality.
3. That following hereinafter is an estimate of the entire cost of the proposed work or improvements, either based upon the Engineer's estimates or based upon actual bids received for said proposed work or improvements by the named municipality.
4. That hereinafter follows an estimate, as to each parcel of property affected, of the assessment of benefits to be levied against each affected parcel.
5. The same is attached hereto and incorporated herein as a schedule of proposed assessments.
6. That it has been determined by the governing body of the aforementioned municipality and the Engineers for the municipality, that the property against which the assessments are made are benefited from said proposed work, improvements and installation of the same, and that all assessments are pursuant to Sections 66.0703(1)(b) Police Powers, and that said assessments are based upon a reasonable basis, as determined by said government body, mainly being construction costs assessment, including actual cost of construction, engineering fees, legal fees, posting and publication expenses.

McMahon Associates, Inc.

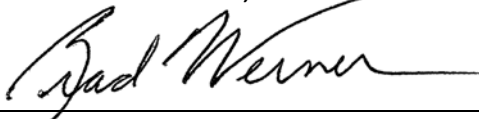
By:   
\_\_\_\_\_  
Brad D. Werner, P.E.  
Vice President / Senior Municipal Engineer



# ENGINEER'S REPORT

## 2024 MINI-STORM SEWER CONSTRUCTION SIDNEY STREET | KIMBERLY AVENUE TO PAPERMILL RUN

PREPARED FOR

### VILLAGE OF KIMBERLY

OUTAGAMIE COUNTY, WISCONSIN

### PURPOSE OF THE MINI-STORM SEWER PROJECT

The purpose of the project is to provide the abutting property owners with a dependable mini-storm sewer and/or lateral to collect sump pump discharge, in conformance with the Village of Kimberly Mini-Storm Sewer Policy adopted March 15, 1993.

### ESTABLISHMENT OF THE SIDNEY STREET MINI-STORM SEWER ASSESSMENT RATE

#### PROJECT COSTS

These costs are estimated and include construction costs, engineering, legal and contingencies or the construction of mini-storm sewer and laterals to the street right-of-way.

Item	Qty/Unit	Description	Unit Price	Total
B-1	1 L.S.	Mobilization	\$1,500.00/L.S.	\$1,500.00
B-2	18 Ea.	Terrace Tree Removal Including Stump	\$400.00/Ea.	\$7,200.00
B-3	2,900 L.F.	6 Inch Schedule 40 PVC Mini-Storm	\$27.00/L.F.	\$78,300.00
B-4	44 Ea.	4 Inch Schedule 40 PVC Storm Lateral	\$850.00/Ea.	\$37,400.00
B-5	5 Ea.	6 Inch Mini-Storm Cleanout	\$500.00/Ea.	\$2,500.00
B-6	1 L.S.	Turf Restoration	\$13,000.00/L.S.	\$13,000.00
B-7	1 L.S.	Concrete Apron Restoration	\$7,500.00/L.S.	\$7,500.00
		Construction Total		\$147,400.00
		20% Engineering & Contingencies		\$29,480.00
		<b>Estimated Total Project Cost</b>		<b>\$176,880.00</b>

# ESTABLISHMENT OF THE SIDNEY STREET MINI-STORM SEWER ASSESSMENT RATE

## MINI-STORM ASSESSMENT RATE

This rate is established by dividing the total cost by the number of properties served. At this time, the project is an estimate, therefore, the rate shown is also an estimate. The final assessment rate should be equal to this estimate or lower. The Village of Kimberly Mini-Storm Policy states that 70% of the project cost shall be assessed to the serviced properties.

Total Estimated Project Cost .....	\$176,880.00
Total Frontage .....	2,517.80/L.F.
Total Assessment Rate .....	\$70.25/L.F.
<b>Estimated Net Assessment Rate (70% x Total).....</b>	<b>\$49.18/L.F.</b>

## PRIVATE STORM LATERAL WORK

The following are unit prices for private storm lateral work required to extend the lateral from the right-of-way to the home connection. The homeowner may choose to have the Village contractor due this work. An estimate can be provided, and a Waiver of Special Assessment is required to be signed by the homeowner. Only turf restoration is included in the cost of lateral. Specialized landscaping or pavement is not included, and the homeowner is responsible for restoring.

### GENERAL ESTIMATE

Item	Qty/Unit	Description	Unit Price	Total
43.	40 L.F.	4" Storm Sewer Lateral (Private) with Turf Restoration	\$40.00/L.F.	\$1,600.00
44.	1 Ea.	Collection Riser at House (Private)	\$150.00/Ea.	\$150.00
<b>Estimated Cost</b>				<b>\$1,750.00</b>

## FINANCING OF ASSESSMENTS

The Village of Kimberly has budgeted funds for the financing of the project and will assess the cost back to the adjacent property owners on a front foot basis. The assessments are billed to the property owners on a selected payment plan. The total assessment balance can also be paid in full. The interest rate to the property owners will be at prime plus 1%. The final interest rate will be provided at the public hearing.

## PLANS & SPECIFICATIONS

As part of this Engineer’s Report, plans and specifications, as prepared by McMahon Associates, Inc., Project No. K0001-09-24-00159.00 are hereby attached.

## PUBLIC HEARING

The Village of Kimberly will hear all persons interested, or their agents or attorneys, concerning matters contained in the Preliminary Resolution Authorization, such assessments, and the Reports of the Engineers at 6:00 p.m. on the 25<sup>th</sup> day of March 2024, in the Village of Kimberly Municipal Building located at 515 W. Kimberly Avenue, Kimberly, Wisconsin

BID TABULATION

**OWNER:** VILLAGE OF KIMBERLY  
**Project Name:** Welhouse Drive & Curtin Avenue Sanitary, Water & Storm Sewer Reconstruction  
**Contract No.** K0001-09-23-00727.02  
**Bid Date/Time:** March 12, 2024 @ 10:00 a.m.  
**Project Manager:** Brad Werner, PE

**Engineer:** McMAHON ASSOCIATES, INC.  
1445 McMahon Drive  
PO Box 1025  
Neenah, WI 54956 / 54957-1025

JOSSART BROTHERS, INC.  
1682 Swan Road  
De Pere, WI 54115

DONALD HIETPAS & SONS, INC.  
1450 E. North Avenue  
PO Box 166  
Little Chute, WI 54150

TRIPLE P. INC. dba  
PETERS CONCRETE CO.  
1526 Atkinson Drive  
Green Bay, WI 54303

PTS CONTRACTORS, INC.  
4075 Eaton Road  
Green Bay, WI 54311

DE GROOT, INC.  
4201 Champion Road  
Green Bay, WI 54311

**SANITARY SEWER**

Item	Qty	Unit	Description	Unit Price	Total	Unit Price	Total	Unit Price	Total	Unit Price	Total	Unit Price	Total
1.	1	L.S.	Mobilization	\$5,000.00	\$5,000.00	\$4,125.00	\$4,125.00	\$10,000.00	\$10,000.00	\$3,325.00	\$3,325.00	\$2,525.00	\$2,525.00
2.	1,959	L.F.	8 Inch SDR 35 PVC Sanitary Sewer	\$60.00	\$117,540.00	\$76.05	\$148,981.95	\$84.60	\$165,731.40	\$88.00	\$172,392.00	\$68.59	\$134,367.81
3.	152	L.F.	4 Inch Sanitary Lateral - Excavated	\$52.00	\$7,904.00	\$69.50	\$10,564.00	\$95.80	\$14,561.60	\$130.00	\$19,760.00	\$61.96	\$9,417.92
4.	900	L.F.	4 Inch HDPE DR 17 Sanitary Lateral - Pipe Burst	\$5.15	\$4,635.00	\$5.05	\$4,545.00	\$5.00	\$4,500.00	\$5.30	\$4,770.00	\$5.20	\$4,680.00
5.	46	Ea.	4" x 8" Wye Connection Including Riser	\$200.00	\$9,200.00	\$498.75	\$22,942.50	\$165.00	\$7,590.00	\$300.00	\$13,800.00	\$839.55	\$38,619.30
6.	66	V.F.	48 inch Sanitary Manhole	\$425.00	\$28,050.00	\$452.00	\$29,832.00	\$425.00	\$28,050.00	\$530.00	\$34,980.00	\$493.18	\$32,549.88
7.	6	Ea.	Manhole Casting	\$550.00	\$3,300.00	\$550.00	\$3,300.00	\$550.00	\$3,300.00	\$875.00	\$5,250.00	\$599.94	\$3,599.64
8.	1	L.S.	Post-Construction Mainline Cleaning and Televising	\$2,520.00	\$2,520.00	\$2,475.00	\$2,475.00	\$1.00	\$1.00	\$2,590.00	\$2,590.00	\$2,676.50	\$2,676.50
9.	46	Ea.	Post-Construction Lateral Televising	\$101.00	\$4,646.00	\$100.00	\$4,600.00	\$100.00	\$4,600.00	\$100.00	\$4,600.00	\$106.05	\$4,878.30
10.	1	L.S.	Sanitary Sewer Trench Compaction and Certification	\$3,500.00	\$3,500.00	\$2,180.00	\$2,180.00	\$3,000.00	\$3,000.00	\$4,800.00	\$4,800.00	\$6,918.50	\$6,918.50
<b>SUB-TOTAL (Items 1. through 10., Inclusive)</b>					<b>\$186,295.00</b>		<b>\$233,545.45</b>		<b>\$241,334.00</b>		<b>\$266,267.00</b>		<b>\$240,232.85</b>

**SANITARY LATERAL WORK ON PRIVATE PROPERTY**

Item	Qty	Unit	Description	Unit Price	Total	Unit Price	Total	Unit Price	Total	Unit Price	Total	Unit Price	Total
11.	1,100	L.F.	4 inch HDPE DR 17 Sanitary Lateral - Pipe Burst	\$5.15	\$5,665.00	\$5.05	\$5,555.00	\$5.00	\$5,500.00	\$5.30	\$5,830.00	\$5.20	\$5,720.00
12.	1	Ea.	Outside Spot Excavation	\$620.00	\$620.00	\$600.06	\$600.06	\$600.00	\$600.00	\$635.00	\$635.00	\$624.18	\$624.18
13.	1	Ea.	Outside Cleanout with Frost Sleeve	\$775.00	\$775.00	\$757.50	\$757.50	\$750.00	\$750.00	\$795.00	\$795.00	\$780.23	\$780.23
14.	30	Ea.	Inside Excavation for Reconnection	\$3,040.00	\$91,200.00	\$2,980.00	\$89,400.00	\$3,000.00	\$90,000.00	\$3,125.00	\$93,750.00	\$3,068.89	\$92,066.70
15.	60	Ea.	4 Inch Furnco Connection	\$10.30	\$618.00	\$10.10	\$606.00	\$10.00	\$600.00	\$10.60	\$636.00	\$10.40	\$624.00
16.	90	Ea.	4 Inch Bend	\$20.60	\$1,854.00	\$20.20	\$1,818.00	\$20.00	\$1,800.00	\$21.00	\$1,890.00	\$20.81	\$1,872.90
17.	30	Ea.	Inside Cleanout	\$103.00	\$3,090.00	\$101.00	\$3,030.00	\$100.00	\$3,000.00	\$105.00	\$3,150.00	\$104.03	\$3,120.90
18.	30	Ea.	Cleanout Cap	\$10.30	\$309.00	\$10.10	\$303.00	\$10.00	\$300.00	\$10.60	\$318.00	\$10.40	\$312.00
19.	30	Ea.	Floor Drain	\$154.50	\$4,635.00	\$151.50	\$4,545.00	\$150.00	\$4,500.00	\$158.00	\$4,740.00	\$156.05	\$4,681.50
20.	150	BAG	Redi-Crete Floor Restoration	\$41.20	\$6,180.00	\$40.40	\$6,060.00	\$40.00	\$6,000.00	\$42.00	\$6,300.00	\$41.61	\$6,241.50
21.	1	Ea.	CIPP Liner Set Up Cost	\$515.00	\$515.00	\$505.00	\$505.00	\$500.00	\$500.00	\$530.00	\$530.00	\$555.50	\$555.50
22.	40	L.F.	4 Inch CIPP Liner	\$82.40	\$3,296.00	\$81.00	\$3,240.00	\$80.00	\$3,200.00	\$84.00	\$3,360.00	\$83.22	\$3,328.80
<b>SUB-TOTAL (Items 11. through 22., Inclusive)</b>					<b>\$118,757.00</b>		<b>\$116,419.56</b>		<b>\$116,750.00</b>		<b>\$121,934.00</b>		<b>\$119,928.21</b>

**WATER MAIN**

Item	Qty	Unit	Description	Unit Price	Total	Unit Price	Total	Unit Price	Total	Unit Price	Total	Unit Price	Total
23.	1	L.S.	Mobilization	\$1,500.00	\$1,500.00	\$1,500.00	\$1,500.00	\$100.00	\$100.00	\$3,325.00	\$3,325.00	\$2,020.00	\$2,020.00
24.	1	L.S.	Temporary Water Service	\$13,000.00	\$13,000.00	\$17,500.00	\$17,500.00	\$29,700.00	\$29,700.00	\$15,050.00	\$15,050.00	\$18,180.00	\$18,180.00
25.	1,890	L.F.	8 Inch PVC Water Main	\$73.00	\$137,970.00	\$80.50	\$152,145.00	\$92.35	\$174,541.50	\$91.00	\$171,990.00	\$78.66	\$148,667.40
26.	30	L.F.	6 Inch PVC Water Main	\$65.00	\$1,950.00	\$70.00	\$2,100.00	\$79.50	\$2,385.00	\$113.00	\$3,390.00	\$68.88	\$2,066.40
27.	4	Ea.	8 Inch Valve	\$2,850.00	\$11,400.00	\$2,500.00	\$10,000.00	\$2,600.00	\$10,400.00	\$2,585.00	\$10,340.00	\$2,902.74	\$11,610.96
28.	3	Ea.	7.5 Foot Bury Hydrant	\$5,600.00	\$16,800.00	\$5,530.00	\$16,590.00	\$5,565.00	\$16,695.00	\$5,625.00	\$16,875.00	\$6,272.10	\$18,816.30
29.	4	Ea.	Salvage Existing Hydrant	\$500.00	\$2,000.00	\$755.00	\$3,020.00	\$500.00	\$2,000.00	\$465.00	\$1,860.00	\$707.00	\$2,828.00
30.	1,372	L.F.	1 Inch Water Service - Excavated	\$50.00	\$68,600.00	\$52.65	\$72,235.80	\$60.45	\$82,937.40	\$63.00	\$86,436.00	\$50.50	\$69,286.00
31.	44	Ea.	1 Inch Service Set	\$500.00	\$22,000.00	\$550.00	\$24,200.00	\$675.00	\$29,700.00	\$576.00	\$25,344.00	\$1,088.92	\$47,912.48
32.	1	L.S.	Water Main Trench Compaction and Certification	\$3,500.00	\$3,500.00	\$2,180.00	\$2,180.00	\$3,000.00	\$3,000.00	\$3,700.00	\$3,700.00	\$7,070.00	\$7,070.00
<b>SUB-TOTAL (Items 23. through 32., Inclusive)</b>					<b>\$278,720.00</b>		<b>\$301,470.80</b>		<b>\$351,458.90</b>		<b>\$338,310.00</b>		<b>\$328,457.54</b>

**STORM SEWER**

Item	Qty	Unit	Description	Unit Price	Total	Unit Price	Total	Unit Price	Total	Unit Price	Total	Unit Price	Total
33.	1	L.S.	Remove Storm Manhole in Fulcer Avenue Terrace	\$500.00	\$500.00	\$650.00	\$650.00	\$750.00	\$750.00	\$580.00	\$580.00	\$1,010.00	\$1,010.00
34.	42	V.F.	4 Foot Diameter Storm Manhole	\$595.00	\$24,990.00	\$547.00	\$22,974.00	\$541.00	\$22,722.00	\$528.00	\$22,176.00	\$633.96	\$26,626.32
35.	6	Ea.	Storm Manhole Casting	\$550.00	\$3,300.00	\$525.00	\$3,150.00	\$495.00	\$2,970.00	\$850.00	\$5,100.00	\$579.74	\$3,478.44
36.	14	Ea.	Inlet with Casting and Drain Tile Stubs	\$3,900.00	\$54,600.00	\$3,485.00	\$48,790.00	\$4,035.00	\$56,490.00	\$5,615.00	\$78,610.00	\$3,623.33	\$50,726.62
37.	383	L.F.	21 Inch Storm Sewer	\$113.00	\$43,279.00	\$119.50	\$45,768.50	\$140.65	\$53,868.95	\$137.00	\$52,471.00	\$125.11	\$47,917.13
38.	980	L.F.	18 Inch Storm Sewer	\$72.00	\$70,560.00	\$82.75	\$81,095.00	\$96.15	\$94,227.00	\$94.00	\$92,120.00	\$85.23	\$83,525.40
39.	340	L.F.	15 Inch Storm Sewer	\$65.00	\$22,100.00	\$73.50	\$24,990.00	\$91.50	\$31,110.00	\$85.00	\$28,900.00	\$77.86	\$26,472.40
40.	460	L.F.	12 Inch Storm Sewer	\$60.00	\$27,600.00	\$67.75	\$31,165.00	\$78.30	\$36,018.00	\$84.00	\$38,640.00	\$75.96	\$34,941.60
41.	14	Ea.	4 Inch Storm Lateral Connection to Main	\$250.00	\$3,500.00	\$275.00	\$3,850.00	\$250.00	\$3,500.00	\$270.00	\$3,780.00	\$537.90	\$7,530.60
42.	454	L.F.	4 Inch Storm Sewer Lateral (Public)	\$47.00	\$21,338.00	\$46.15	\$20,952.10	\$58.70	\$26,649.80	\$58.00	\$26,332.00	\$50.90	\$23,108.60
43.	560	L.F.	4 Inch Storm Sewer Lateral (Private) with Turf Restoration	\$40.00	\$22,400.00	\$51.00	\$28,560.00	\$56.00	\$31,360.00	\$73.00	\$40,880.00	\$54.22	\$30,363.20
44.	14	Ea.	Collection Riser at House (Private)	\$150.00	\$2,100.00	\$180.00	\$2,520.00	\$250.00	\$3,500.00	\$310.00	\$4,340.00	\$223.72	\$3,132.08
45.	1	L.S.	Storm Sewer Clean and Televise	\$2,800.00	\$2,800.00	\$2,731.00	\$2,731.00	\$1.00	\$1.00	\$2,860.00	\$2,860.00	\$2,929.00	\$2,929.00
46.	1	L.S.	Storm Sewer Trench Compaction and Certification	\$3,000.00	\$3,000.00	\$2,180.00	\$2,180.00	\$2,000.00	\$2,000.00	\$3,700.00	\$3,700.00	\$6,918.50	\$6,918.50
<b>SUB-TOTAL (Items 33. through 46., Inclusive)</b>					<b>\$302,067.00</b>		<b>\$319,375.60</b>		<b>\$365,166.75</b>		<b>\$400,489.00</b>		<b>\$348,679.89</b>

**BID TABULATION**

**OWNER:** VILLAGE OF KIMBERLY  
**Project Name:** Welhouse Drive & Curtin Avenue Sanitary, Water & Storm Sewer Reconstruction  
 Contract No. K0001-09-23-00727.02  
**Bid Date/Time:** March 12, 2024 @ 10:00 a.m.  
**Project Manager:** Brad Werner, PE

**Engineer:** McMAHON ASSOCIATES, INC.  
 1445 McMahon Drive  
 PO Box 1025  
 Neenah, WI 54956 / 54957-1025

JOSSART BROTHERS, INC.  
 1682 Swan Road  
 De Pere, WI 54115

DONALD HIETPAS & SONS, INC.  
 1450 E. North Avenue  
 PO Box 166  
 Little Chute, WI 54150

TRIPLE P. INC. dba  
 PETERS CONCRETE CO.  
 1516 Atkinson Drive  
 Green Bay, WI 54303

PTS CONTRACTORS, INC.  
 4075 Eaton Road  
 Green Bay, WI 54311

DE GROOT, INC.  
 4201 Champion Road  
 Green Bay, WI 54311

**MISCELLANEOUS**

Item	Qty	Unit	Description	Unit Price	Total	Unit Price	Total	Unit Price	Total	Unit Price	Total	Unit Price	Total
47.	1	L.S.	Erosion Control - Inlet Protection and Maintenance	\$1,500.00	\$1,500.00	\$2,020.00	\$2,020.00	\$1,500.00	\$1,500.00	\$1,600.00	\$1,600.00	\$3,030.00	\$3,030.00
48.	1	L.S.	Concrete Pavement Removal	\$15,000.00	\$15,000.00	\$48,000.00	\$48,000.00	\$5,000.00	\$5,000.00	\$15,900.00	\$15,900.00	\$7,575.00	\$7,575.00
49.	1	L.S.	Rough Grading	\$7,500.00	\$7,500.00	\$1,000.00	\$1,000.00	\$6,400.00	\$6,400.00	\$1,500.00	\$1,500.00	\$3,535.00	\$3,535.00
50.	1	L.S.	Tree Removal (70 Trees)	\$28,000.00	\$28,000.00	\$27,580.00	\$27,580.00	\$27,300.00	\$27,300.00	\$28,400.00	\$28,400.00	\$28,400.19	\$28,400.19
51.	47	Ea.	Remove Mailbox	\$50.00	\$2,350.00	\$75.00	\$3,525.00	\$90.00	\$4,230.00	\$60.00	\$2,820.00	\$151.50	\$7,120.50
52.	47	Ea.	Temporary Mailbox	\$100.00	\$4,700.00	\$50.00	\$2,350.00	\$90.00	\$4,230.00	\$25.00	\$1,175.00	\$2,525.00	\$118,675.00
<b>SUB-TOTAL (Items 47. through 52., Inclusive)</b>				<b>\$59,050.00</b>		<b>\$84,475.00</b>		<b>\$48,660.00</b>		<b>\$51,395.00</b>		<b>\$168,335.69</b>	
<b>TOTAL (Items 1. through 52., Inclusive)</b>				<b>\$944,889.00</b>		<b>\$1,055,286.41</b>		<b>\$1,123,369.65</b>		<b>\$1,178,395.00</b>		<b>\$1,205,634.18</b>	

**ALTERNATE BID A | KENNEDY AVENUE DRAIN TILE**

Item	Qty	Unit	Description	Unit Price	Total	Unit Price	Total	Unit Price	Total	Unit Price	Total	Unit Price	Total
A-1	2,570	L.F.	6 Inch Drain Tile with Sock with Turf Restoration	\$24.00	\$61,680.00	\$25.65	\$65,920.50	\$28.75	\$73,887.50	\$42.00	\$107,940.00	\$38.13	\$97,994.10
A-2	11	Ea.	Connect to Inlet per Detail	\$500.00	\$5,500.00	\$500.00	\$5,500.00	\$1,065.00	\$11,715.00	\$750.00	\$8,250.00	\$812.60	\$8,938.60
A-3	2	Ea.	Inserta Tee Connection	\$250.00	\$500.00	\$300.00	\$600.00	\$450.00	\$900.00	\$1,610.00	\$3,220.00	\$1,028.18	\$2,056.36
<b>TOTAL ALTERNATE BID A (Items A-1 through A-3, Inclusive)</b>				<b>\$67,680.00</b>		<b>\$72,020.50</b>		<b>\$86,502.50</b>		<b>\$119,410.00</b>		<b>\$108,989.06</b>	

**ALTERNATE BID B | SIDNEY STREET MINI-STORM SEWER**

Item	Qty	Unit	Description	Unit Price	Total	Unit Price	Total	Unit Price	Total	Unit Price	Total	Unit Price	Total
B-1	1	L.S.	Mobilization	\$1,500.00	\$1,500.00	\$3,520.00	\$3,520.00	\$4,000.00	\$4,000.00	\$5,815.00	\$5,815.00	\$2,020.00	\$2,020.00
B-2	18	Ea.	Terrace Tree Removal Including Stump	\$400.00	\$7,200.00	\$550.00	\$9,900.00	\$390.00	\$7,020.00	\$470.00	\$8,460.00	\$404.00	\$7,272.00
B-3	2,900	L.F.	6 Inch Schedule 40 PVC Mini-Storm	\$27.00	\$78,300.00	\$33.70	\$97,730.00	\$49.50	\$143,550.00	\$34.00	\$98,600.00	\$44.38	\$128,702.00
B-4	44	Ea.	4 Inch Schedule 40 PVC Storm Lateral	\$850.00	\$37,400.00	\$775.00	\$34,100.00	\$1,750.00	\$77,000.00	\$1,290.00	\$56,760.00	\$1,262.17	\$55,535.48
B-5	5	Ea.	6 Inch Mini-Storm Cleanout	\$500.00	\$2,500.00	\$555.00	\$2,775.00	\$750.00	\$3,750.00	\$765.00	\$3,825.00	\$787.80	\$3,939.00
B-6	1	L.S.	Turf Restoration	\$13,000.00	\$13,000.00	\$13,635.00	\$13,635.00	\$7,575.00	\$7,575.00	\$14,320.00	\$14,320.00	\$18,685.00	\$18,685.00
B-7	1	L.S.	Concrete Apron Restoration	\$7,500.00	\$7,500.00	\$11,250.00	\$11,250.00	\$100.00	\$100.00	\$2,650.00	\$2,650.00	\$21,210.00	\$21,210.00
<b>TOTAL ALTERNATE BID B (Items B-1 through B-7, Inclusive)</b>				<b>\$147,400.00</b>		<b>\$172,910.00</b>		<b>\$242,995.00</b>		<b>\$190,430.00</b>		<b>\$237,363.48</b>	

Bid Security	5% Bid Bond	5% Bid Bond	5% Bid Bond	5% Bid Bond	5% Bid Bond
Addendum Acknowledgement	Yes - #1 and #2	Yes - #1 and #2	Yes - #1 and #2	Yes - #1 and #2	Yes - #1 and #2

	Subcontractor	Subcontractor	Subcontractor	Subcontractor	Subcontractor
<i>Pipe Bursting</i>	Scott Lamers Construction	Scott Lamers Construction	Scott Lamers Construction	Scott Lamers Construction	Scott Lamers Construction
<i>Testing</i>	Speedy Clean	Speedy Clean			Speedy Clean
<i>Traffic Control</i>		Corey Gordon Work Zone	Gordon Work Zone	Gordon Work Zone	
<i>Tree Removal</i>		On Site Logging	On Site Logging		On Site Logging



## ASSESSMENT SCHEDULE

### 2024 MINI-STORM SEWER CONSTRUCTION

SIDNEY STREET | KIMBERLY AVENUE TO PAPERMILL RUN  
 Village of Kimberly | Outagamie County, Wisconsin

Mini-Storm Rate = \$49.18

Property Owner	Property Address	Parcel No.	Frontage	Estimated Mini-Storm Assessment
SPRANGERS, KIMBERLY L	115 N. Sidney Street	250000600	75.80	\$3,727.84
KOBS, BRIAN	116 N. Sidney Street	250013600	60.00	\$2,950.80
B2 RENTALS LLC	122 N. Sidney Street	250013700	60.00	\$2,950.80
STECKBAUER, STEPHEN	123 N. Sidney Street	250000700	60.00	\$2,950.80
HOWARD, BENJAMIN THOMAS	129 N. Sidney Street	250000800	60.00	\$2,950.80
CHRISTIANSEN, JENNIFER	130 N. Sidney Street	250013800	60.00	\$2,950.80
VANROY, TODD J	135 N. Sidney Street	250000900	60.00	\$2,950.80
REIMER, SHARON M	136 N. Sidney Street	250013900	60.00	\$2,950.80
PETERS, TRAVIS S	141 N. Sidney Street	250001000	60.00	\$2,950.80
KAUFERT, DAVID	142 N. Sidney Street	250014000	60.00	\$2,950.80
KRAUSE, GARRY L	146 N. Sidney Street	250014100	60.00	\$2,950.80
BUCHANAN, RANDY R	147 N. Sidney Street	250001100	60.00	\$2,950.80
PEETERS, LUCAS J	204 N. Sidney Street	250007300	56.75	\$2,790.97
SPRANGERS FAMILY ENTERPRISES LLC	208 N. Sidney Street	250007400	56.75	\$2,790.97
VANLITH, PETRANELLA J	209 N. Sidney Street	250007100	56.75	\$2,790.97
BURKE, ROBERT E	213 N. Sidney Street	250007000	56.75	\$2,790.97
GIESEN, CHARLES H	214 N. Sidney Street	250007500	56.75	\$2,790.97
AUFDENKAMP, JOSHUA	219 N. Sidney Street	250006900	56.75	\$2,790.97
BERNARD, BARRY G	220 N. Sidney Street	250007600	56.75	\$2,790.97
MARTIN, LAURA M	225 N. Sidney Street	250006800	56.75	\$2,790.97
MORROW, BRUCE E	226 N. Sidney Street	250007700	56.75	\$2,790.97
CCA RENTALS LLC	231 N. Sidney Street	250006700	56.75	\$2,790.97
ELIASON, BRENTON	232 N. Sidney Street	250007800	56.75	\$2,790.97
LEWIS, BRENDA M	303 N. Sidney Street	250006600	56.75	\$2,790.97
SMITH, MAXWELL	304 N. Sidney Street	250007900	56.75	\$2,790.97
JOHNSON, NICHOLE F	308 N. Sidney Street	250008000	56.75	\$2,790.97
FEAVEL, STEVEN M	309 N. Sidney Street	250006500	56.75	\$2,790.97
BEYERS, JASMIN A	314 N. Sidney Street	250008100	56.75	\$2,790.97
VOSS, JENNIFER L	315 N. Sidney Street	250006400	56.75	\$2,790.97
WELLS, JONATHAN M	318 N. Sidney Street	250008200	56.75	\$2,790.97
DAVIS, JOSEPH J	319 N. Sidney Street	250006300	56.75	\$2,790.97
MARHEINE, MARK V	324 N. Sidney Street	250008300	56.75	\$2,790.97
ZWIERS, ROBERT L	325 N. Sidney Street	250006200	56.75	\$2,790.97
PATRICK, ROBERT M	330 N. Sidney Street	250008400	56.75	\$2,790.97
LORNSON, DAVID J	331 N. Sidney Street	250006100	56.75	\$2,790.97
SCHOLL, PHILLIP R	403 N. Sidney Street	250004500	60.00	\$2,950.80
WALKER, THOMAS J	409 N. Sidney Street	250004302	60.00	\$2,950.80
HEATON, JOSEPH T	415 N. Sidney Street	250004301	60.00	\$2,950.80
ESTEVEZ GARCIA, CARLOS E	421 N. Sidney Street	250004200	60.00	\$2,950.80
LOOK, CRYSTAL	427 N. Sidney Street	250004100	60.00	\$2,950.80
VANG, IA	433 N. Sidney Street	250004000	60.00	\$2,950.80
STERR, MASON	439 N. Sidney Street	250003900	60.00	\$2,950.80
NEW PARTNERS LLC	116 W. Maes Avenue	250007200	56.75	\$2,790.97
<b>TOTAL</b>			<b>2,517.80</b>	<b>\$123,825.40</b>